



- (GB) INSTALLATION INSTRUCTIONS
- (D) MONTAGEANLEITUNG
- (FR) INSTRUCTIONS DE MONTAGE
- (I) MANUALE DI INSTALLAZIONE

Dog Guard Divider / Hundeschutztrenngitter / Séparateur de grille pare-chien / Separatore di griglia per cani

Part Number/Teilenummer/ Numéro de pièce / Codice pezzo: F555EAJ300

Application/Montage/Montage/Montaggio: '10MY~ LEGACY WAGON/OUTBACK

To be used with F555EAJ200 / Zu verwenden mit F555EAJ200
 Compatible seulement avec F555EAJ200 / Compatibile solo con F555EAJ200

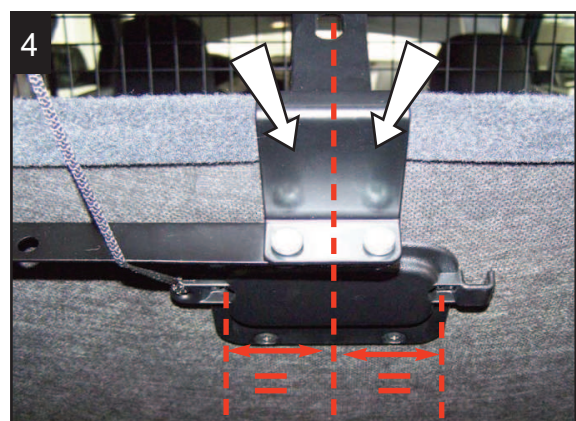
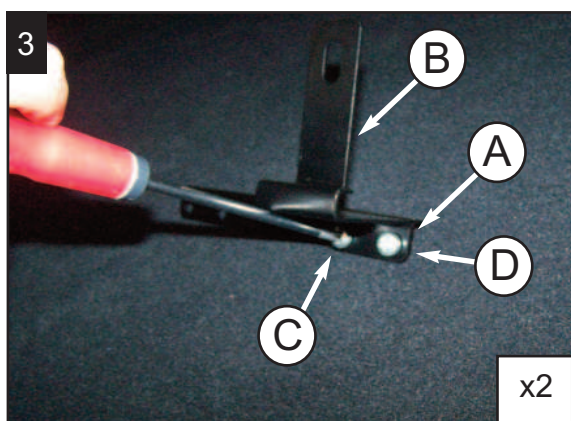
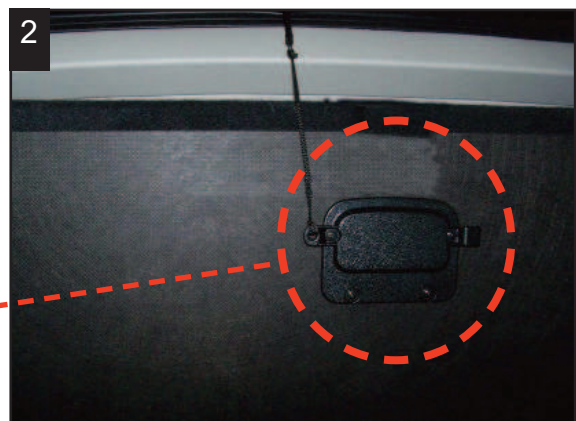
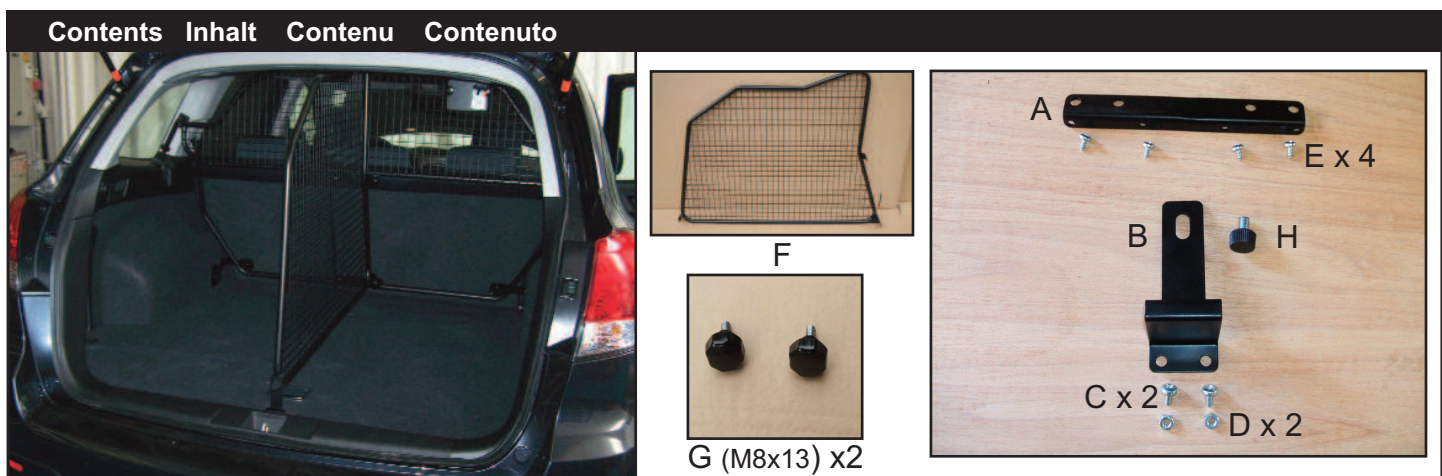

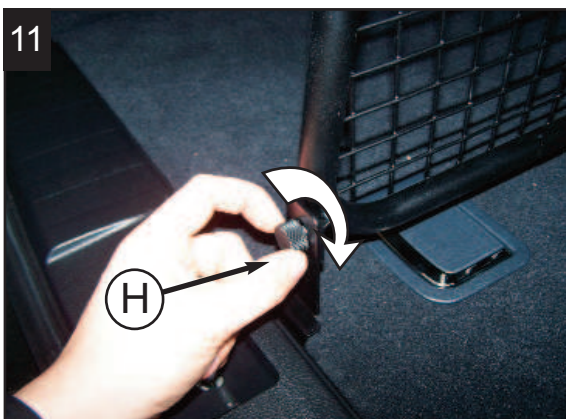
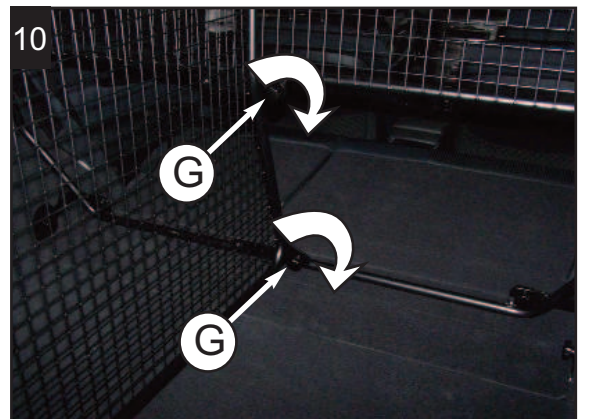
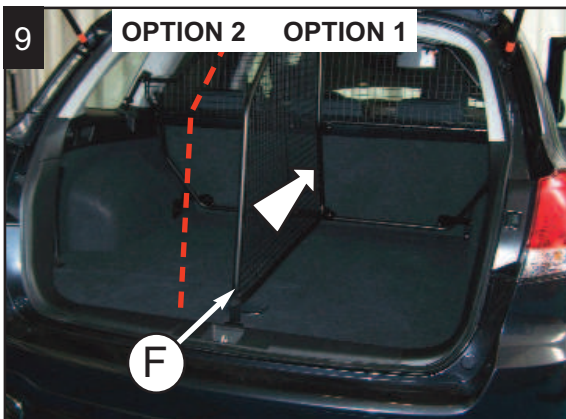
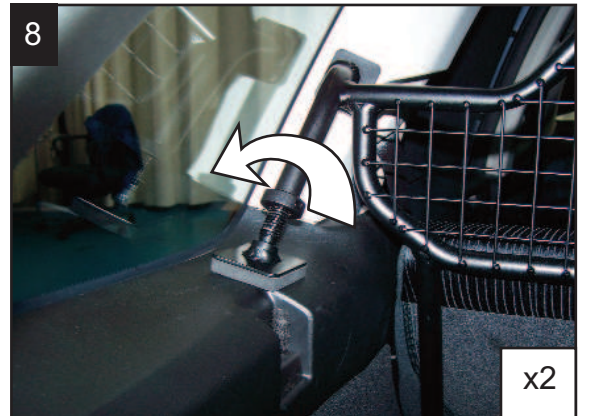
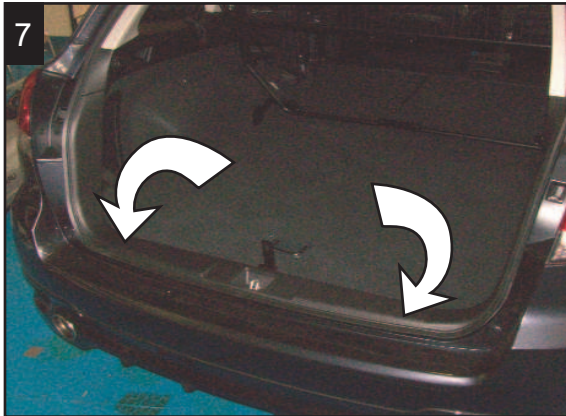
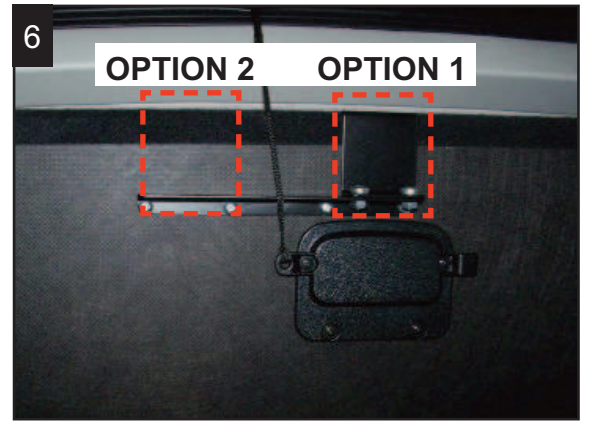
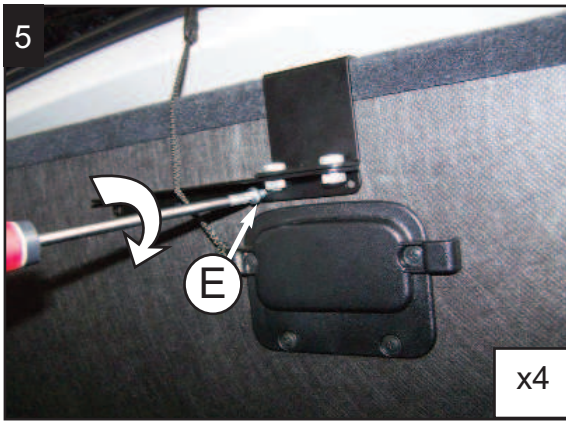

DO NOT OVERTIGHTEN – CHECK ALL FIXINGS PERIODICALLY TO ENSURE CORRECT TENSION
 VERBINDUNGEN NICHT ZU FEST ANZIEHEN – KONTROLLIEREN SIE REGELMÄßIG DEN FESTSITZ ALLER VERBINDUNGEN
 NE PAS SERRER EXCESSIVEMENT – VEILLEZ À VÉRIFIER RÉGULIÈREMENT L'EMPLACEMENT ET LE SERRAGE DES VIS
 ET DES BOULONS.
 NON STRINGERE TROPPO - CONTROLLARE PERIODICAMENTE TUTTI I PUNTI DI FISSAGGIO IN MODO DA GARANTIRE
 UNA TENSIONE CORRETTA