





- (GB) INSTALLATION INSTRUCTIONS
- (D) MONTAGEANLEITUNG
- (FR) INSTRUCTIONS DE MONTAGE
- (I) MANUALE DI INSTALLAZIONE

Dog guard / Laderaumtrenngitter / Grille pour chiens / Griglia per cani

Part Number/Teilenummer/ Numéro de pièce / Codice pezzo: F555EAJ200

Application/Montage/Montage/Montaggio: '10MY~ LEGACY WAGON/OUTBACK

Contents Inhalt Contenu Contenuto



A 1xL/H 1xR/H



B (M6x25) x2

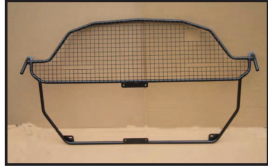

C



D (M8x13) x2



E x2

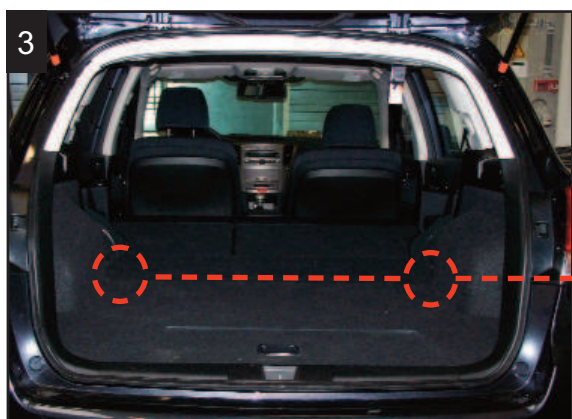
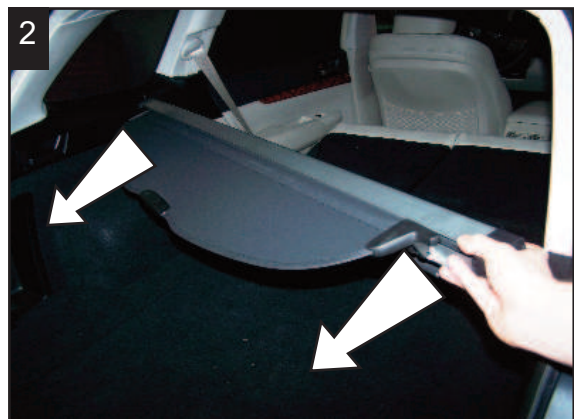

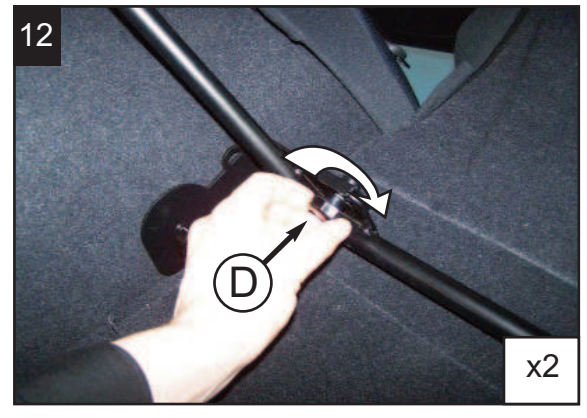
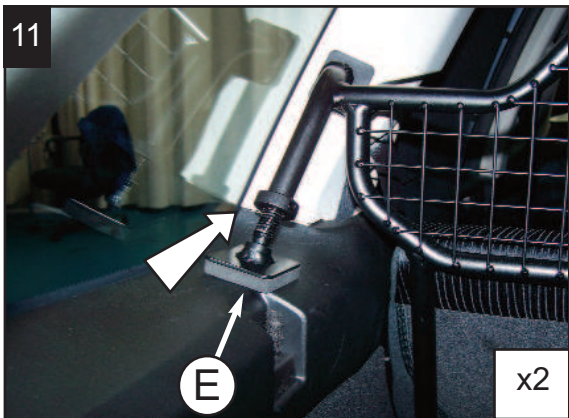
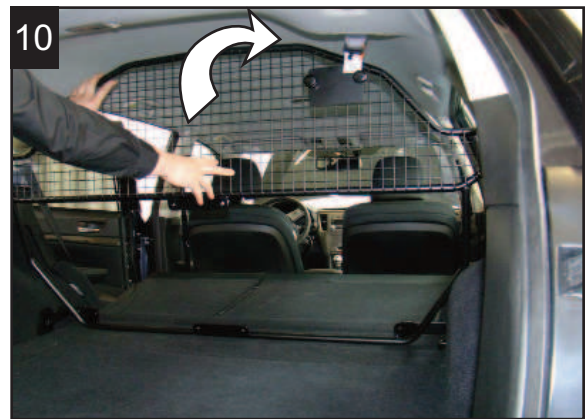
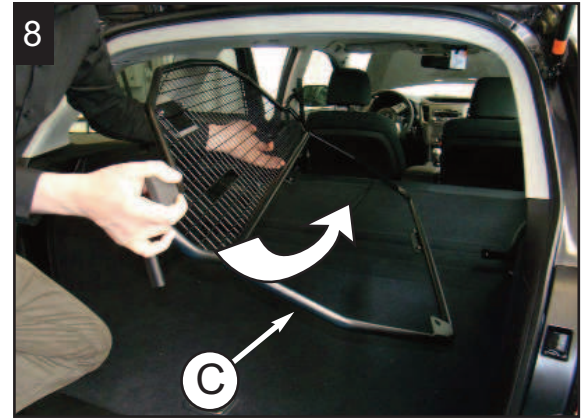
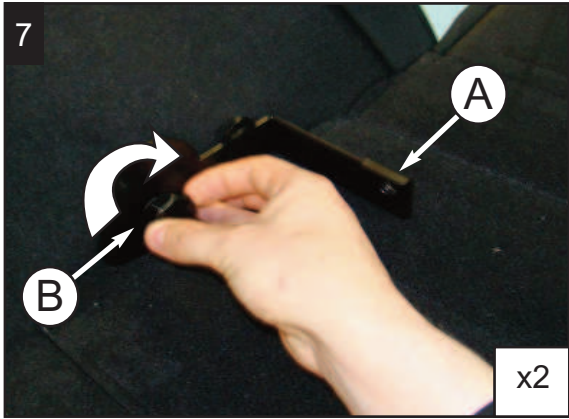
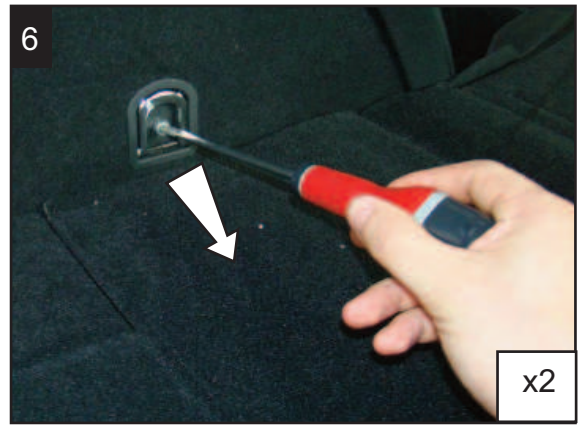
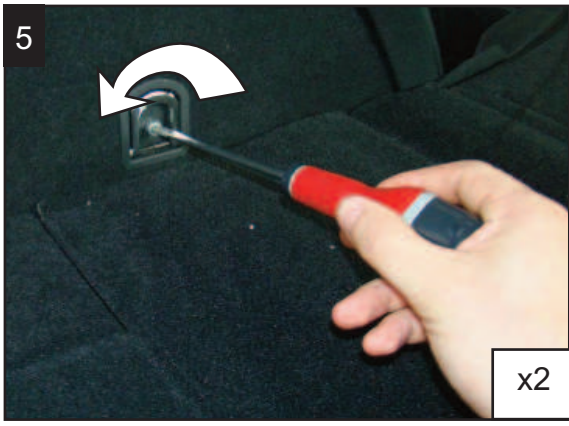

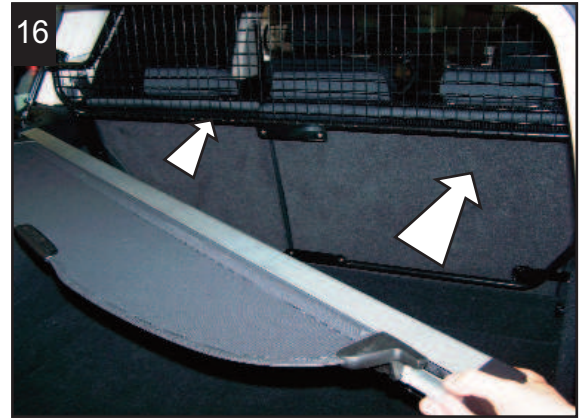
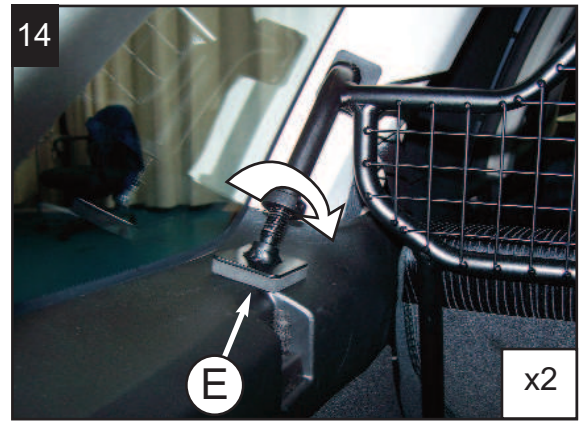
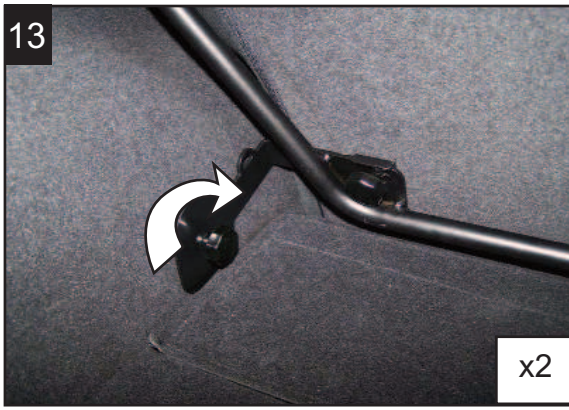

DO NOT OVERTIGHTEN – CHECK ALL FIXINGS PERIODICALLY TO ENSURE CORRECT TENSION

VERBINDUNGEN NICHT ZU FEST ANZIEHEN – KONTROLLIEREN SIE REGELMÄßIG DEN FESTSITZ ALLER VERBINDUNGEN

NE PAS SERRER EXCESSIVEMENT – VEILLENZ À VÉRIFIER RÉGULIÈREMENT L'EMPLACEMENT ET LE SERRAGE DES VIS ET DES BOULONS

NON STRINGERE TROPPO - CONTROLLARE PERIODICAMENTE TUTTI I PUNTI DI FISSAGGIO IN MODO DA GARANTIRE UNA TENSIONE CORRETTA