



SUBARU

LEGACY Installation manual

Name : SPLASH GUARD/FRONT KIT
Part No. : J1010AJ001
J1010AJ021

Component parts

No.	Part name	Quantity
①	Splash Guard F-RH	1
②	Splash Guard F-LH	1
③	J-Nut	6
④	Screw	6
⑤	Washer	6
⑥	Push Rivet	2
⑦	Installation Instruction	1

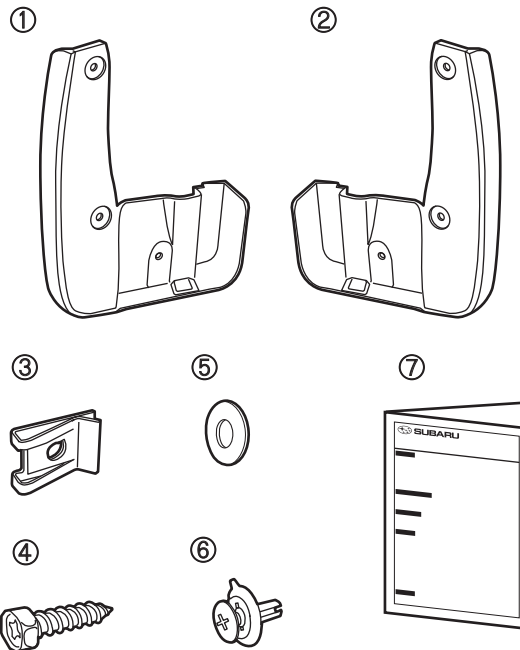

Tools



Clean shop towel
Chiffon d'atelier propre
Sauberer Lappen
Panno da officina pulito
Paño de taller limpio



Phillips screwdriver
Tournevis plus
Kreuzschlitz-Schraubendreher
Cacciavite a croce
Destornilladores de cabeza en cruz

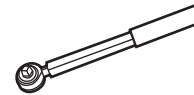

Torque wrench
Clé dynamométrique
Drehmomentschlüssel
Chiave torsiometrica
Llave dinamométrica

Work outline

1

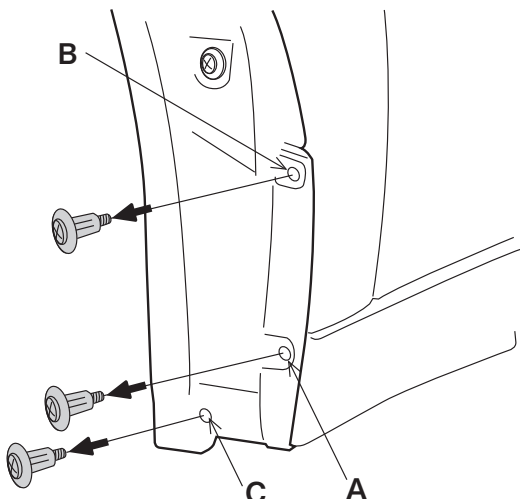

Clean the splash guard installation surface.
Remove clips A , B and C.

Nettoyer la surface d'installation de la bavette garde-boue.
Déposer les circlips A , B et C.

Die Anbaufläche des Spitzblechs reinigen.
Die Klammern A , B und C entfernen.

Pulire la superficie di installazione del paraspruzzi.
Rimuovere i morsetti A , B e C.

Limpiar la superficie de instalación del protector contra salpicaduras.
Extraiga los retenedores A , B y C.

Hardware Kit : J1010AJ007

2

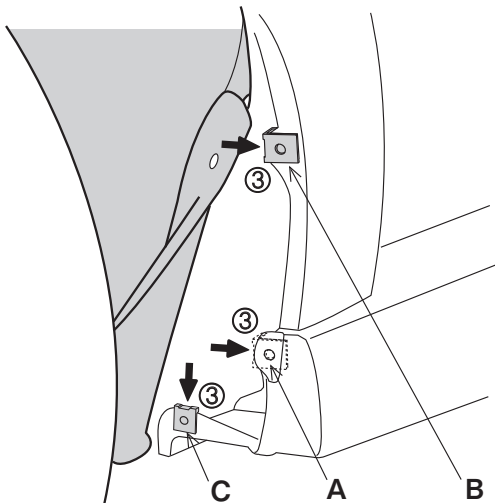

Install the J-nuts at locations A,B & C.

Installer l'écrou à ressort en J A,B et C.

Die J-Nutter anbringen A,B und C.

Installare il dado J A,B e C.

Instale la tuerca en J A,B y C.

3

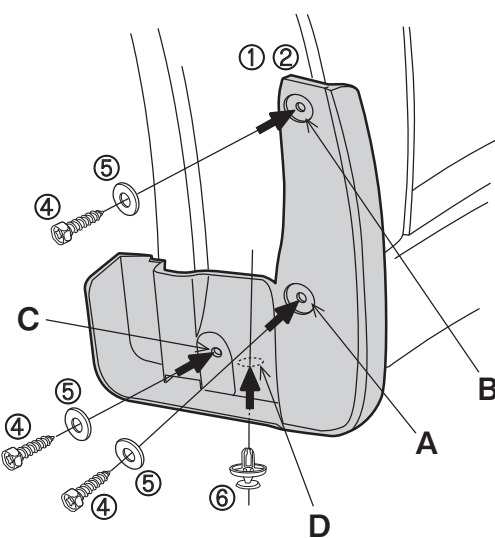

Loosely install screw and washers at locations A,B & C.
Hold Splash Guard in place and install Push Rivet at location D.
Hold inward pressure on Splash Guard while tightening.
Tightening Torque: 180-220 N·cm (16-19.5 in-lbs)
Repeat installation process for other side.

Fixer à l'aide du boulon et de sa rondelle A,B et C.
Couple de serrage: 180 à 220 N·cm
Fermer les circlip D.

Mit der Schraube und der Unterlegscheibe befestigen A,B und C.
Anzugsdrehmoment: 180 bis 220 N·cm
Mit den Klammern sichern D.

Fissare poi con il bullone e la rondella A,B e C.
Coppia di serraggio: da 180 a 220 N·cm
Fermare con i morsetti D.

Fije con el perno y la arandela A,B y C.
Torsión de apriete: 180 a 220 N·cm
Fije con los retenedores D.