

INSTRUCTION

Attention:

This adapter/bracket is an "exchange" adapter that makes it possible to replace the original mounted armrest with a "MLC310" centre Comfort armrest - which will offer you a more convenient drive due to it's adjustable features and practical storage compartment box.

Please note that this adapter only is adaptable with the armrest type "MLC310" and only can be mounted on seats that already is equipped with an original mounted armrest.

For more information about adapters suitable for other type of seats -please contact your dealer or visit Comfort's official homepage where you will find information about adaptations for more than 200 different car models.

Official homepage:

www.armrest.info

Innehåll / Content / Inhalt:

1 st Adapter /Bracket
1 st Cover-Ring
1 st M10x16 Insex-screw
1 st Plastic Cap (Black)
1 st insex-rod for M4

Type No / Art.No:

Prototype

Bil/ Car/ Auto Model: År / Year / Jahre:

Mazda 5 3/2005 -

Tillverkad av / Manufactured by / Hersteller:

Sydmeke Industri AB
Santessonsväg 3, 232 91 Arlööv, Sweden
Phone: +46 40 83640, Fax: +46 40 89090
E-mail: office@sydmeke.se
Homepage: www.sydmeke.com

Comfort
ARMREST SYSTEM

R-registered trademark of Sydmeke Industri AB

Adapter Bracket



Armrest MLC310



Mount the armrest like this:



Remove the original armrest by folding away the upholstery and then un-zipp the zipper.



Use a 14 mm box-spanner to loose the centre screw on the armrest.

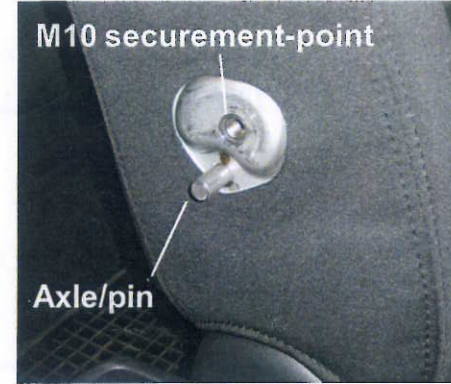

Remove the armrest and locate the two fastening points -the axle/pin and the M10 securement point.



Place the cover-ring over the adapter bracket and mount the bracket over the axle-pin (so that it entry into the spline-tube)



Secure the armrest by tighten the M10 inset-screw (use 8 mm inset-rod) and then cover the screw with the enclosed plastic-cap.

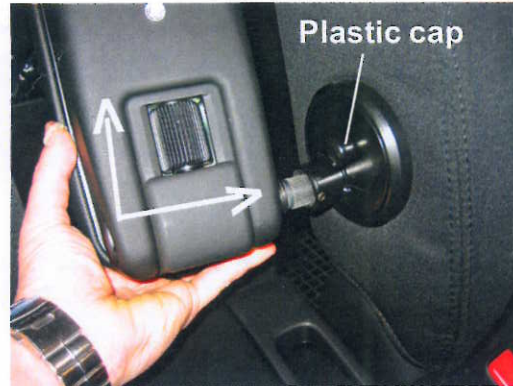

Mount the armrest into the spline-tube in a backfolded position and make sure the armrest stops in line with the seat.

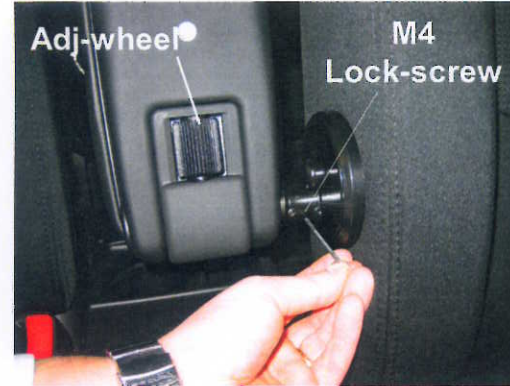

Secure the armrest on the adapter by tighten the M4 «lock-screw» (placed on the spline-tube). Then fold down the armrest and adjust the angle into a nice and relaxing position. Do not lean on the armrest while you adjust it!



Follow this instruction if the armrest is to be mounted on the **left hand side** of the car seat.

B

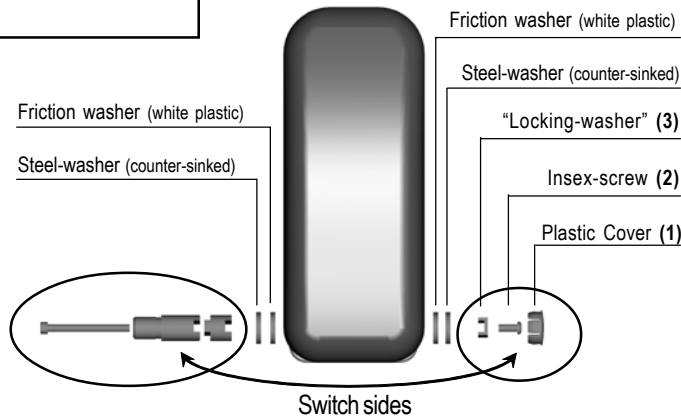

When mounting the armrest on the left hand side of the car-seat (UK- & Asian markets) you have to make special preparations before you can mount the axle on the right side of the armrest. Please follow the instructions down below:

Remove the plastic cover (1) loose the insex-screw (2) and the "locking-washer" (3) and re-mount them on the opposite side of the armrest -together with the friction washer and the steel-washer. Then mount the axle on the right side of the armrest, according to the instructions in picture A.

Axle-cover instruction

C

Without the 15 mm extension distance
-use the short axle-cover (L= 20 mm).

With the 15 mm extension distance
-use the long axle-cover (L= 38 mm).



Place the axle-cover 5-10 mm behind the splines on the axle...

... then push the armrest/axle all the way into the adapter so that the axle-cover have contact with the spline-case on the adapter.